

LIST PRICING &
PRODUCT SPECIFICATIONS
Effective November 2016



BUILDERS MARK
FROM WOLF HOME PRODUCTS™

BUILDERS MARK FROM WOLF HOME PRODUCTS

THE BUDGET-FRIENDLY CHOICE

Whether you're creating a large decorative space or building a small galley kitchen, when you choose Builders Mark cabinets your imagination won't be limited—even if your budget is.

EXCEPTIONAL VALUE

Builders Mark cabinets feature quality wood doors and face frames and come with fully adjustable ½" shelves, fully concealed self-closing hinges and an easy-clean interior. Plus, you can choose from a variety of smart storage solutions as well as functional and decorative accessories to make any size project your own.

BUY WITH CONFIDENCE

You can be confident when buying Builders Mark cabinets. In addition to certifications from the Kitchen Cabinet Manufacturers Association (KCMA), Builders Mark comes with a 2-year warranty.

DOORS

SIERRA

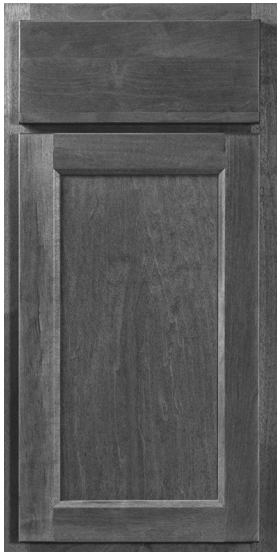

Espresso



Harvest Brown



Graphite



Auburn



Nutmeg

- Stained maple
- Standard overlay
- Mortise and tenon, flat panel door; solid wood drawer front
- Solid-wood face frames dadoed and joined with wood screws or dowels
- 1/2" industrial-grade furniture board drawers and cabinet sides
- Side-mounted drawer guides and fully captured drawer bottoms
- Durable finish resists scratches, dents and dings
- Easy-clean interior

MESA



Espresso

- Stained maple veneer
- Full overlay
- Slab door and drawer with vertical grain
- Solid-wood face frames dadoed and joined with wood screws or dowels
- 1/2" industrial-grade furniture board drawers and cabinet sides
- Side-mounted drawer guides and fully captured drawer bottoms
- Durable finish resists scratches, dents and dings
- Easy-clean interior

PRODUCT CHARACTERISTICS

NATURAL BEAUTY OF WOOD

Wood is a natural product with variations in grain, texture and color. As a result of natural conditions, some species will develop characteristics such as burls, pecks, pin burls, shakes, split knots and mineral streaks to name a few. In some instances, even the color will vary greatly within a single piece of wood or cabinet component. A certain amount of variations is allowed and, in fact, is desirable. Doors with these types of characteristics are not to be considered defective. Natural and light finishes will not cover any naturally occurring variation. In addition, all wood will age over time deepening or mellowing its tone. These characteristics are not to be misinterpreted as defects. Wood is a product of nature- and as such will display natural characteristics and variances that are unique to each and every cut. These characteristics are an integral part of the charm and beauty of real wood.

CRYSTALLINE WATER BASED FINISH

Builders Mark Cabinets feature our Crystalline Water Based Finish which is healthier for our environment and more durable than conventional finishes. Our USA Made low volatile organic compounds (VOC's) clear coats and stains are water based, formaldehyde free, non-yellowing and UV cured for a very durable surface. Builders Mark Crystalline Water Base Finish will exceed the coating life of a conventional conversion varnish by up to 10 years while providing a brighter appearance and more depth of color than conventional coatings.

CABINET SPECIFICATIONS

WALL CABINET CONSTRUCTION

- A** 1/2" industrial-grade furniture-board top
- B** Fully concealed, adjustable hinge
- C** 1/2" industrial-grade furniture-board adjustable shelf
- D** Low-pressure melamine interior with light maple finish
- E** 1/2" industrial-grade furniture-board hanging rail
- F** 1/2" industrial-grade furniture-board bottom
- G** 1/8" laminated MDF cabinet back

All face frames are 3/4" x 1 1/2" wood.

All single-door cabinets are hinged left.

- Wall cabinets can be flipped during installation for right hinge applications

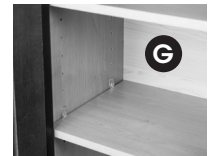
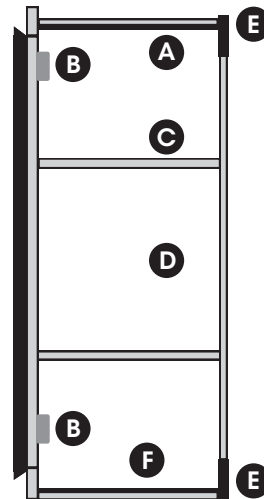

BASE CABINET CONSTRUCTION

- 1** 1/2" industrial-grade furniture-board drawer box in light maple stain
- 2** Side-mounted, epoxy-coated, 75 lbs. nylon, lubricated roller glides
- 3** Fully concealed, adjustable hinge
- 4** 1/2" industrial-grade furniture-board, half-depth fixed shelf
- 5** Low-pressure melamine interior with light maple finish
- 6** 1/2" industrial-grade furniture-board hanging rail
- 7** 1/8" laminated MDF cabinet back
- 8** 1/2" industrial-grade furniture-board bottom
- 9** 1/2" furniture-board toekick

All face frames are 3/4" x 1 1/2" wood.

All single-door cabinets are hinged left.

- Base, tall and vanity cabinet doors will be reversed during installation for right hinge applications

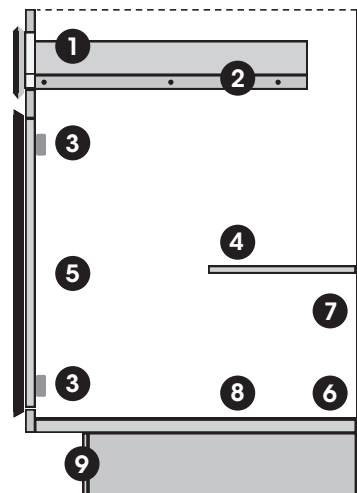

WALL CABINETS

12" WALL CABINET

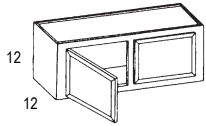

	Cubes	Sierra/Mesa
W3012	4	204
W3312	4	213
W3612	5	229
W3912	6	246

- 12" deep
- Double doors
- No shelf

18" WALL CABINET

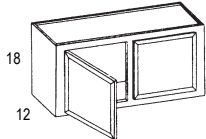

	Cubes	Sierra/Mesa
W2418DD	4	211
W3018	5	204
W3318	6	213
W3618	6	229
W3918	7	238

- 12" deep
- Double doors
- No shelf
- 24" DD comes with double butt doors

30" SINGLE DOOR WALL CABINET

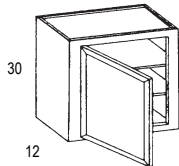

	Cubes	Sierra/Mesa
W0930	3	176
W1230	4	188
W1530	5	192
W1830	5	196
W2130	6	225

- 12" deep
- Single door
- Two adjustable shelves
- Hinged left

36" SINGLE DOOR WALL CABINET

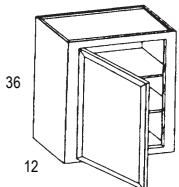

	Cubes	Sierra/Mesa
W0936	4	202
W1236	5	215
W1536	6	223
W1836	6	227
W2136	7	258

- 12" deep
- Single door
- Two adjustable shelves
- Hinged left

42" SINGLE DOOR WALL CABINET

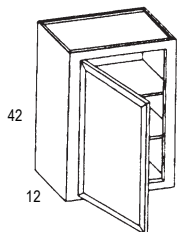

	Cubes	Sierra/Mesa
W0942	4	223
W1242	4	236
W1542	7	242
W1842	6	246
W2142	7	285

- 12" deep
- Single door
- Three adjustable shelves
- Hinged left

WALL CABINETS

15" DOUBLE DOOR WALL CABINET

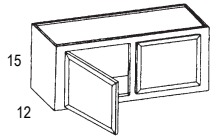

	Cubes	Sierra/Mesa
W3015	4	204
W3315	5	213
W3615	6	229

- 12" deep
- Double doors
- No shelf

24" DOUBLE DOOR WALL CABINET

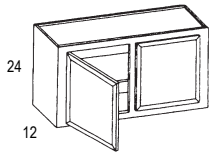

	Cubes	Sierra/Mesa
W2424DD	5	242
W3024	7	221
W3324	7	229
W3624	8	238
W3924	9	249

- 12" deep
- Double doors
- No shelf
- 24" DD comes with double butt doors

30" DOUBLE DOOR WALL CABINET

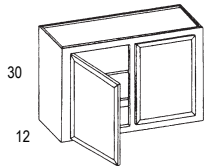

	Cubes	Sierra/Mesa
W2430DD	7	279
W2730	7	253
W3030	8	270
W3330	9	287
W3630	10	304
W3930	10	315
W4230	11	332

- 12" deep
- Double doors
- Two adjustable shelves
- 24" DD comes with double butt doors

36" DOUBLE DOOR WALL CABINET

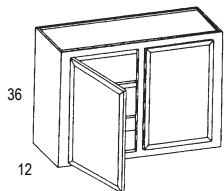

	Cubes	Sierra/Mesa
W2436DD	8	319
W2736	8	293
W3036	9	313
W3336	10	332
W3636	10	349
W3936	11	368
W4236	12	381

- 12" deep
- Double doors
- Two adjustable shelves
- 24" DD comes with double butt doors

42" DOUBLE DOOR WALL CABINET

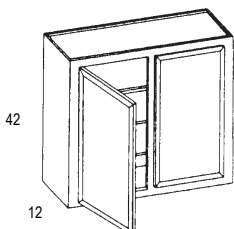

	Cubes	Sierra/Mesa
W2442DD	8	349
W2742	8	317
W3042	10	340
W3342	10	361
W3642	11	383
W3942	11	406
W4242	12	429

- 12" deep
- Double doors
- Three adjustable shelves
- 24" DD comes with double butt doors

WALL CABINETS

24" REFRIGERATOR WALL CABINET

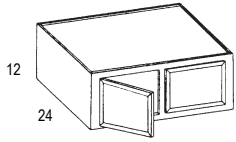

	Cubes	Sierra/Mesa
RW3612	8	294
RW3618	10	294
RW3624	11	303
RW3912	7	314
RW3918	10	324
RW3924	13	328

- 24" deep
- Double doors
- 12" & 18" tall cabinets do not include shelves
- 24" cabinets include 1 shelf

15" DEEP WALL CABINETS

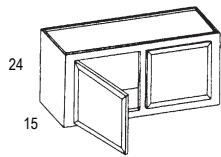

	Cubes	Sierra/Mesa
W302415	8	255

- 15" deep
- Double doors

DIAGONAL WALL CABINET

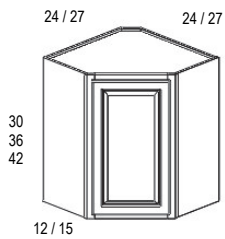

	Cubes	Sierra/Mesa
WDC2430	13	355
WDC2436	15	466
WDC2442	16	557
WDC2742	16	590

- 30" and 36" have 2 adjustable shelves
- 42" has 3 adjustable shelves
- Hinged left

WALL CABINETS

WALL CORNER CABINETS

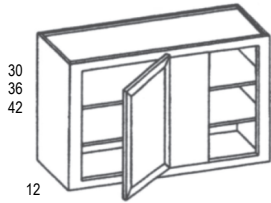

	Cubes	Sierra/Mesa
WC3030	8	270
WC3630	9	304
WC4230	10	332
WC3036	9	313
WC3636	10	349
WC4236	12	394
WC3042	10	340
WC3642	11	383
WC4242	12	429

- 12" deep; single door hinged left; two shelves; blind cabinets can be pulled 3"
- 30" cabinets come with two shelves
- 36" and 42" cabinets come with three shelves
- 42" cabinets have double doors
- Center stile and blind opening are 6" wide on all sizes
- Does not include filler or panel to cover blind opening

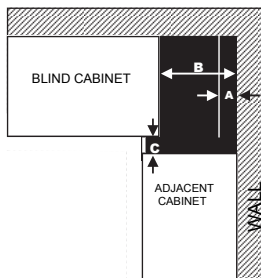

	Actual Cabinet Width	A. Min. Pull (cabinet face frame from wall)	B. Max. Pull (cabinet face frame from wall)	C. Min. Filler Required	C. Max. Filler with 1-1/2" hardware
WC3030, 3036, 3042	30"	0	3"	1/2"	2"
WC3630, 3636, 3642	36"	0	3"	1/2"	2"
WC4230, 4236, 4242	42"	0	3"	1/2"	2"

Blind openings are on right side; cabinet will be flipped during installation for left blind applications

KEY

- A = Minimum pull for Square Corner cabinets
- B = Maximum pull for Square Corner cabinets
- C = Minimum filler size required between cabinets

BASE CABINETS

SINGLE DOOR BASE CABINET

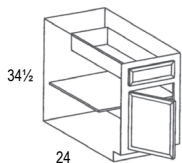

	Cubes	Sierra/Mesa
B09	6	258
B12	7	266
B15	9	274
B18	10	279
B21	12	304

- 24" deep
- Single door
- One drawer EXCEPT B09 has full height door and no drawer
- 1 fixed half-depth shelf

DRAWER BASE CABINET

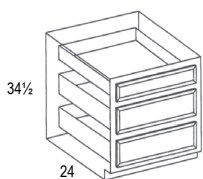

	Cubes	Sierra/Mesa
DB12	7	336
DB15	9	345
DB18	10	349
DB21	12	370
DB24	13	394
DB30	17	443
DB36	20	493

- 24" deep
- Three drawers

BASE CORNER CABINET

	Cubes	Sierra/Mesa
BC36	20	345
BC39	20	377
BC42	22	411

- 24" deep
- Double doors
- One drawer
- 1 fixed half-depth shelf
- Does not include filler or panel to cover blind opening

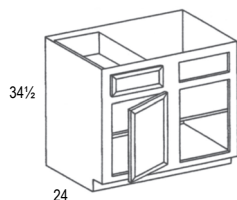

Base Corner - BC36
Center Stile: 6"
Blind opening = 9"

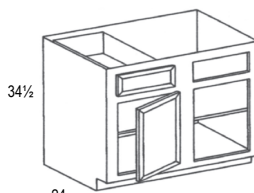

Base Corner - BC39
Center Stile: 6"
Blind opening = 12"

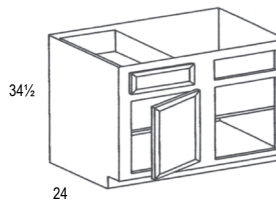

Base Corner - BC42
Center Stile: 6"
Blind opening = 15"

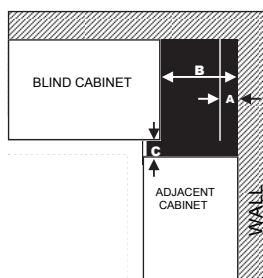

	Actual Cabinet Width	A. Min. Pull (cabinet face frame from wall)	B. Max. Pull (cabinet face frame from wall)	C. Min. Filler Required	C. Max. Filler with 1-1/2" hardware
BC36	27"	9"	12"	1/2"	2"
BC39	33"	9"	9"	1/2"	2"
BC42	39"	3"	6"	1/2"	2"

Blind openings are on right side; door and drawer will be reversed during installation for left blind applications

KEY

- A = Minimum pull for Square Corner cabinets
- B = Maximum pull for Square Corner cabinets
- C = Minimum filler size required between cabinets

BASE CABINETS

BASE CORNER LAZY SUSAN

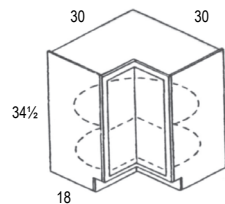

	Cubes	Sierra/Mesa
LS36	30	543

- Two rotating shelves attached to doors
- Door rotates with shelves

DOUBLE DOOR BASE CABINET

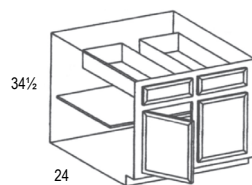

	Cubes	Sierra/Mesa
B24DD	13	377
B27	15	345
B30	17	357
B33^	18	377
B36^	20	398
B39^	21	411
B42^	23	415

- 24" deep
- Double doors
- 1 fixed half-depth shelf
- 24DD has double butt doors and no center stile

^To avoid racking during shipping, these cabinets come with a shipping brace that can be removed during installation.

SINK BASE CABINET

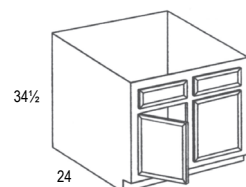

	Cubes	Sierra/Mesa
SB24DD	14	319
SB27	16	328
SB30	18	332
SB33	19	340
SB36	20	357
SB39	22	370
SB42	23	385

- 24" deep
- Double doors
- No drawers
- Two false front
- 24DD has double butt doors and no center stile with one false drawer front

SINK / RANGE FRONTS

SINK / RANGE FRONT DIAGONAL

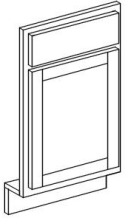

	Cubes	Sierra/Mesa
SCB36FF	2	248
SCB42FF	3	268

	Cubes	Sierra/Mesa
SCB36DFLR	1	89
SCB42DFLR	1	101

- Order floor and toe-kick separately

Diagonal Sink Front Floor

- SCB36FF – 24" x 36" x 18"
- SCB42FF – 24" x 42" x 26"

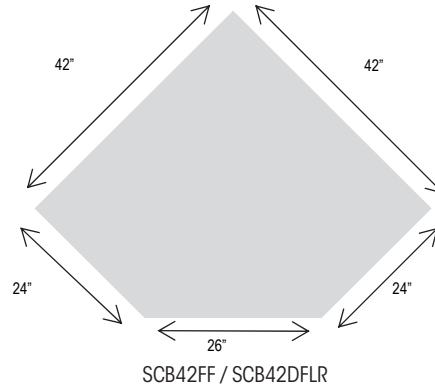
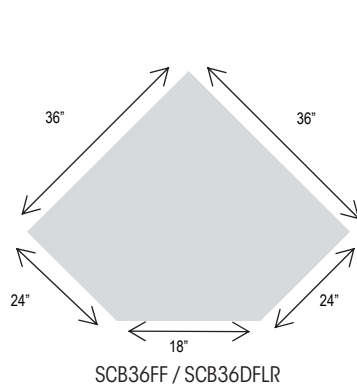

TALL CABINETS

UTILITY CABINET SINGLE DOOR

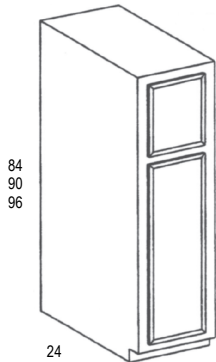

	Cubes	Sierra/Mesa
U1884	24	635
U1890	26	675
U1896	37	713
U1824SHELF	1	55

- 24" deep
- 84" & 90" includes three adjustable shelves
- 96" includes four adjustable shelves
- Unfinished toekick is installed on all units.
- Single doors are hinged left

UTILITY CABINET DOUBLE DOOR

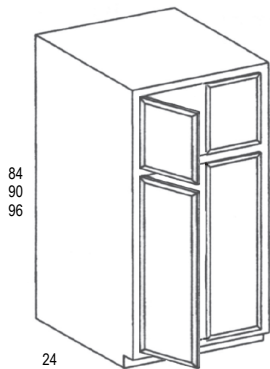

	Cubes	Sierra/Mesa
U2484DD	32	784
U2490DD	34	800
U2496DD	39	845
U2424SHELF	1	55

- 24" deep
- 84" & 90" includes three adjustable shelves
- 96" includes four adjustable shelves
- Unfinished toekick is installed on all units
- Shelf clips must be ordered separately
- 24" DD comes with double upper and lower butt doors

OVEN CABINET

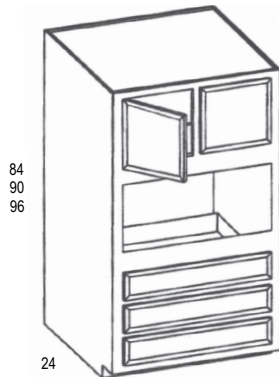

	Cubes	Sierra/Mesa
OC3384	41	1218
OC3390	44	1313
OC3396	47	1414
OC33SHELF	1	55

- Oven Opening - 24" high x 30" wide; Drawers may be removed and cut out to create a Double Oven opening.
- No shelves included in upper cabinet, if desired order OCSHELF below for 90" & 96" tall oven cabinets
- Oven cabinet has a 3" left and right stile running the entire height of the cabinet. OC inside opening is natural

- Full depth 1/2" shelf to add to upper cabinet of 90" & 96" tall cabinets. Shelf clips must be ordered separately.

VANITY CABINETS

VANITY SINK BASE CABINET

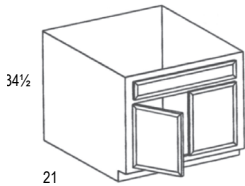

	Cubes	Sierra/Mesa
VSB24DD	10	349
VSB27	12	328
VSB30	13	332
VSB33	14	340

- 21" deep
- Double doors
- No drawers
- 24" DD cabinet comes with double butt doors

VANITY DRAWER BASE CABINET

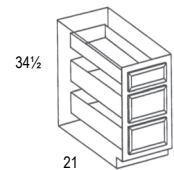

	Cubes	Sierra/Mesa
VDB12	6	348
VDB15	7	352
VDB18	8	357
VDB21	9	385

- 21" deep
- Three drawers

UNDERMOUNT DRAWER

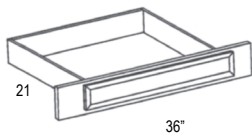

	Cubes	Sierra/Mesa
VDT36	3	149

- 21" deep
- 36" total width trimmable by 6" both sides
- 24" drawer head

VANITY BASE CABINET

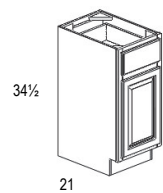

	Cubes	Sierra/Mesa
VB12	6	266
VB15	7	274
VB18	8	279

- 21" deep
- Single door
- One drawer

VANITY SINK BASE CABINET WITH DRAWERS

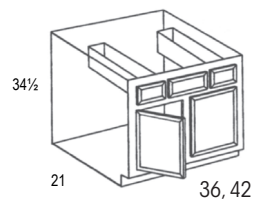

	Cubes	Sierra/Mesa
VSDB36^	15	400
VSDB42^	18	415
VSDB48^	20	449

* VSDB48 includes two drawers and two false fronts

^ To avoid racking during shipping, these cabinets come with a shipping brace that can be removed during installation.

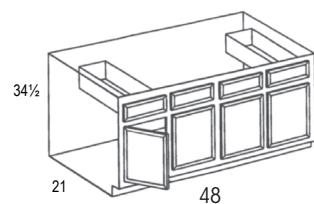

ACCESSORIES

MICROWAVE WALL CABINET

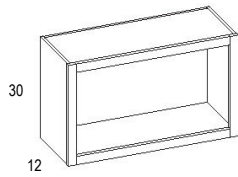

	Cubes	Sierra/Mesa
MWC3018	5	326
MWC30SHELF	5	102

- MWCSHELF: 1/2" X 18" 27"

CORBEL

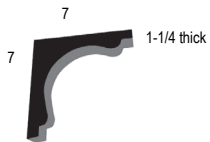

	Cubes	Sierra/Mesa
CORBEL	1	92

VALANCE

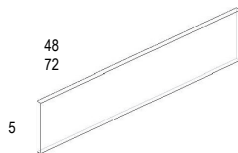

	Cubes	Sierra/Mesa
V548ST	1	64
V572ST	1	75

Straight Valance

- 3/4" thick solid maple
- Valances are finished front side only

FILLER



	Cubes	Sierra/Mesa
F330	.1	22
F630	.2	41
F342	.1	45
F642	.2	79
F396	.1	94
F696	.2	181

Filler

- F330 & F630 may be used for either bases or 30" walls
- All fillers are 3/4" thick solid Maple

Fillers are finished on the face, left, and right hand sides, however the sides receive a lesser finish. If you require an end to be exposed we suggest using a valance.

PULL OUT SHELF FOR BASE & TALL

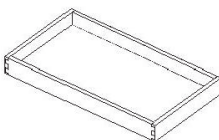

	Cubes	Sierra/Mesa
POS12	1	206
POS15	1	208
POS18	1	212
POS21	1	214
POS24	1	216

- Inside height: 2-1/2"
- Overall height: 3-1/4"
- Pull out shelf includes single drawer box with side mounted epoxy glides, front spacer, and screws for installation
- Single pull out shelf, field installed

PANELS

PANELS

Cubes

List

Below Panels are finished with Low Pressure Melamine

P4834	Finished End Panel — 48" x 34" x 1/4" (grain runs with 34")	1	162
P4896	Finished End Panel — 48" x 96" x 1/4" (grain runs with 96")	1	341
WSKIN30	Finished Panel — 11 1/4" x 30" x 1/8"	.1	40
WSKIN42	Finished Panel — 11 1/4" x 42" x 1/8"	.1	61
BSKIN	Finished Panel — 23 1/4" x 34 1/2" x 1/8"	.1	88
REFP24	Finished Refrigerator Panel — 23 13/16" x 96" with 1 1/2" stile	1	262
3/4REFP24	Finished Refrigerator Panel — 24" x 3/4" x 96" — one 3/4" x 96" is edge banded	1	367
DWP3	Dishwasher End Panel with 3" stile	1	129
Below Panels are actual door panels			
DWEP30	Decorative End Panel for 30" Wall Cabinet — 11" x 28" x 3/4"	.1	122
DWEP36	Decorative End Panel for 36" Wall Cabinet — 11" x 34" x 3/4"	.1	122
DWEP42	Decorative End Panel for 42" Wall Cabinet — 11" x 40" x 3/4"	.1	146
DEPVB	Decorative End Panel for Vanity Base — 19" x 28" x 3/4"	.1	146
DEPB	Decorative End Panel Base Cabinet — 22" x 28" x 3/4"	.1	146

PANELS & MOULDING

Drawings not to scale. Please use dimensions shown. Available in all colors.

STAINED mouldings: MDF core wrapped in Low Pressure Melamine

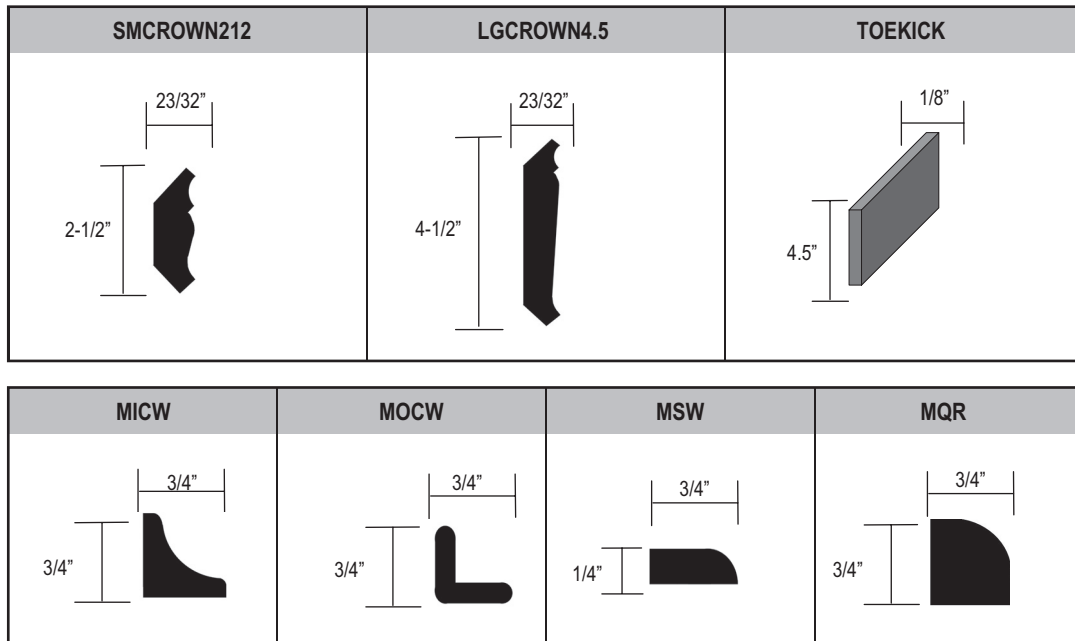

	Cubes	Description	List
SMCROWN212	1	2 1/2" Crown	69
LGCROWN4.5	1	4 1/2" Crown	109
MICW	1	Inside Corner	26
MOCW	1	Outside Corner	26
MSW	1	Scribe	19
MQR	1	Quarter Round	19
TOEKICK	1	4 1/2" Toekick	36

- Available in all colors
- Drawings not to scale. Please use dimensions shown.
- Moulding sold as single 8' piece

UNIVERSAL DESIGN PRODUCTS

Builders Mark Cabinets are also available in Universal Design Specifications.

These Universal Design cabinets are available only on Truckload Orders.

Please work with your Wolf Sales Consultant or Wolf Customer Care to determine your delivery date.

WHAT IS ADA COMPLIANCE VS. UNIVERSAL DESIGN?

ADA compliant cabinets are designed to meet the needs of people with disabilities per the Americans with Disabilities Act. Builders Mark Cabinets offers a reduced height product that may be used in your ADA or UD design. Although product choice does need to be considered, designing for ADA and UD is not just about product, it's mainly about design principles and building codes. For more information about ADA regulations, please visit www.ADA.gov.

ADA compliance is based on the overall height of the workspace, clear floor space, knee clearance and toe clearance combined. All of these elements must be applied together and accurately for your design to be considered ADA complaint. Codes will vary and it is important for you to understand your local codes before starting your design.

Universal Design, also known as Aging in Place Design, is a much broader concept. The goal is to create an environment that is usable, to the greatest extent possible, by people of any age or ability without the need for a special design or adaptation. In order to be considered UD, your design must consider the space needed for approach, reach, manipulation and overall use regardless of the user's body size, posture or mobility.

Universal Design Builders Mark cabinets are 32" in height and have a 4½" toe kick.

All other product specifications are the same as our standard cabinet.

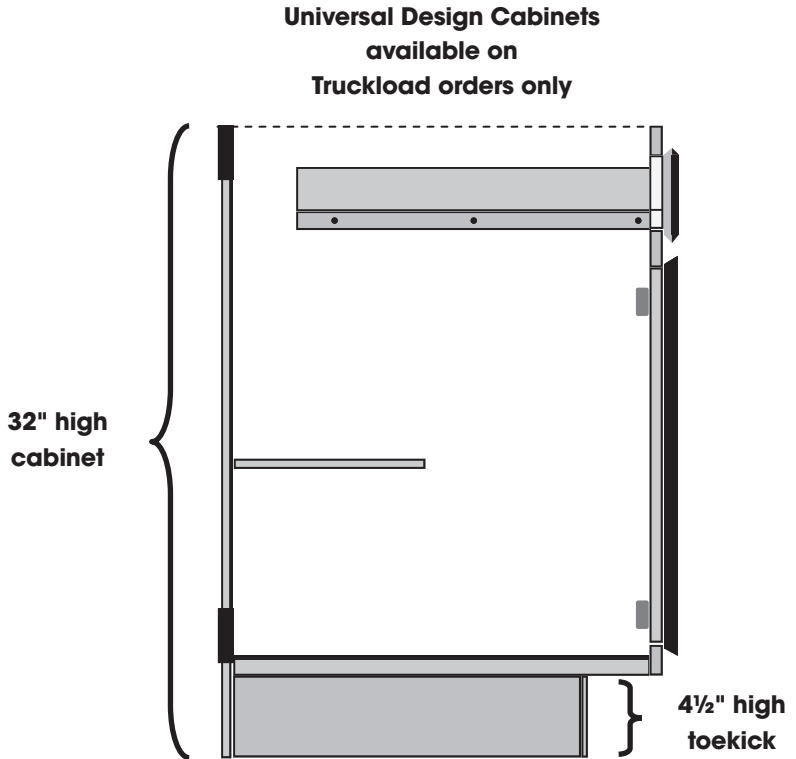

UNIVERSAL DESIGN – 32" HIGH BASE CABINETS

SINGLE DOOR BASE CABINET

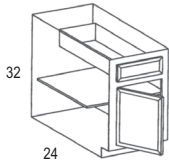

	Cubes	Sierra/Mesa
B09UD	6	271
B12UD	7	279
B15UD	9	288
B18UD	10	293
B21UD	12	319

- 32" high
- 24" deep
- Single door, hinged left
- One drawer EXCEPT B09 has full height door and no drawer and B24D has double butt doors and no center stile
- 1 fixed half-depth shelf

DRAWER BASE CABINET

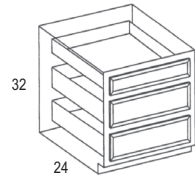

	Cubes	Sierra/Mesa
DB12UD	7	353
DB15UD	9	362
DB18UD	10	366
DB21UD	12	388
DB24UD	13	414
DB30UD	17	465
DB36UD	20	518

- 32" high
- 24" deep
- Three drawers

BASE CORNER CABINET

	Cubes	Sierra/Mesa
BC36UD	20	362
BC39UD	20	396
BC42UD	22	431

- 32" high
- 24" deep
- Double doors
- One drawer
- 1 fixed half-depth shelf
- Does not include filler or panel to cover blind opening

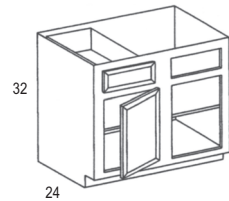

Base Corner - BC36
Center Stile: 6"
Blind opening = 9"

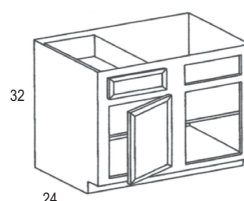

Base Corner - BC39
Center Stile: 6"
Blind opening = 12"

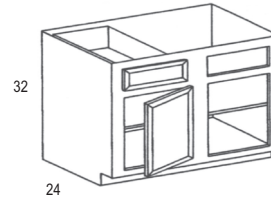

Base Corner - BC42
Center Stile: 6"
Blind opening = 15"

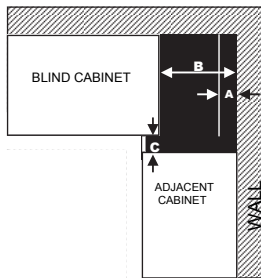

	Actual Cabinet Width	A. Min. Pull (cabinet face frame from wall)	B. Max. Pull (cabinet face frame from wall)	C. Min. Filler Required	C. Max. Filler with 1-1/2" hardware
BC36UD	27"	9"	12"	1/2"	2"
BC39UD	33"	9"	9"	1/2"	2"
BC42UD	39"	3"	6"	1/2"	2"

Blind openings are on right side; door and drawer will be reversed during installation for left blind applications

KEY

- A = Minimum pull for Square Corner cabinets
- B = Maximum pull for Square Corner cabinets
- C = Minimum filler size required between cabinets

UNIVERSAL DESIGN – 32" HIGH BASE CABINETS

REMOVABLE FRONT CABINETS

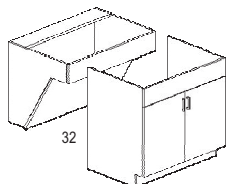

	Cubes	Sierra/Mesa
SB30REMUD	20	526
SB36REMUD	23	552

- 32" high
- 24" deep
- Includes both pieces

DOUBLE DOOR BASE CABINET

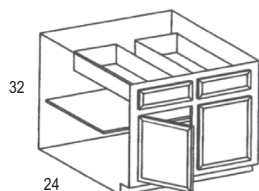

	Cubes	Sierra/Mesa
B24DDUD	13	396
B27UD	15	362
B30UD	17	375
B33UD^	18	396
B36UD^	20	418
B39UD^	21	431
B42UD^	23	436

- 32" high
- 24" deep
- Double doors
- Two drawers
- 1 fixed half-depth shelf
- 24DD has double butt doors and no center stile

^ To avoid racking during shipping, these cabinets come with a shipping brace that can be removed during installation.

SINK BASE CABINET

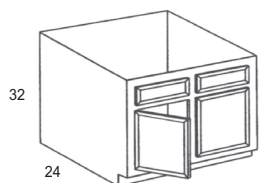

	Cubes	Sierra/Mesa
SB24DDUD	14	336
SB27UD	16	344
SB30UD	17	349
SB33UD	19	358
SB36UD	20	375
SB39UD	22	388
SB42UD	23	405

- 32" high
- 24" deep
- Double doors
- No drawers
- Two false front
- 24DD has double butt doors and no center stile with one false front

UNIVERSAL DESIGN – 32" HIGH VANITY CABINETS

VANITY SINK BASE CABINET DOUBLE DOOR

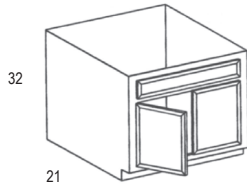

	Cubes	Sierra/Mesa
VSB24DDUD	10	366
VSB27UD	12	344
VSB30UD	13	349
VSB33UD	14	358

- 32" high
- 21" deep
- Double doors
- No drawers
- 24" DD cabinet comes with double butt doors

VANITY DRAWER BASE CABINET

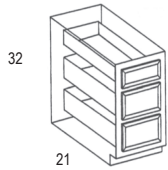

	Cubes	Sierra/Mesa
VDB12UD	6	365
VDB15UD	7	370
VDB18UD	8	375
VDB21UD	9	405

- 32" high
- 21" deep
- Three drawers

REMOVABLE FRONT CABINETS

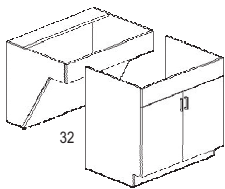

	Cubes	Sierra/Mesa
VSB30REMUD	16	526
VSB36REMUD	18	552

- 32" high
- 21" deep
- Includes both pieces

VANITY BASE CABINET SINGLE DOOR

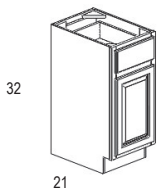

	Cubes	Sierra/Mesa
VB12UD	6	279
VB15UD	7	288
VB18UD	8	293

- 32" high
- 21" deep
- Single door
- One drawer

VANITY SINK BASE CABINET WITH DRAWERS

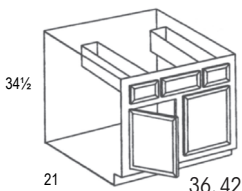

	Cubes	Sierra/Mesa
VSDB36UD^	15	420
VSDB42UD^	18	436
VSDB48UD*^	20	472

- 32" high
- * VSB48 includes two drawers and two false fronts
- ^To avoid racking during shipping, these cabinets come with a shipping brace that can be removed during installation.

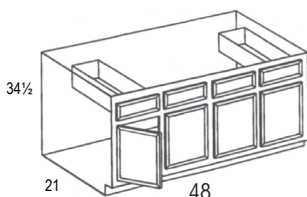

SPECIAL ORDER

15" DEEP WALL CABINETS

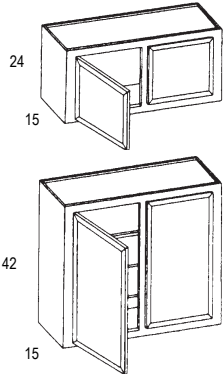

	Cubes	Sierra/Mesa
W362415	9	273
W154215	8	279
W184215	7	283
W244215DD	9	351
W304215	11	392

- 15" deep
- Double doors
- Three adjustable shelves
- W1542 & W1842 come with single door
- To create flush ends with these cabinets, use 1/4" panels: P4834 or P4896

DIAGONAL WALL CABINET

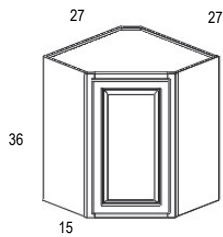

	Cubes	Sierra/Mesa
WDC2736	15	498

- Two adjustable shelves
- Hinged left

SINK / RANGE FRONT STRAIGHT

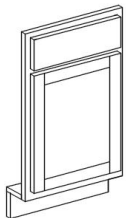

	Cubes	Sierra/Mesa
SF30FF	4	217
SF36FF	5	249

	Cubes	Sierra/Mesa
SF30FLR	1	60
SF36FLR	1	73

- Trimmable by 3"
- Order floor and toe kick separately

Sink Front Floor

- SF30FLR – 23-1/4" x 30"
- SF36FLR – 23-1/4" x 36"

NOTE: This item requires field trimming

Decorative End Panels – Tall Cabinets (actual doors)

DEPTB	Decorative End Panel TALL Cabinet — Bottom section for all Talls	.1	218
DEPT84	Decorative End Panel TALL Cabinet — Top section for 84" cabinet	.1	314
DEPT90	Decorative End Panel TALL Cabinet — Top section for 90" cabinet	.1	362
DEPT96	Decorative End Panel TALL Cabinet — Top section for 96" cabinet	.1	411

TRUCKLOAD GUIDELINES

PRODUCT MIX

Truckload orders must consist of a single door style ordered in one to two stain colors. Special order material must be purchased in truckload quantities. Please be sure to double check your orders to ensure you have not missed any items.

QUANTITY

Truckload orders must fall between a minimum of 2,200 cubes (including panels, mouldings and accessories) or 220 cabinets (not including panels, mouldings and accessories) and a maximum of 3,100 cubes or 310 cabinets. Any ordered material exceeding the maximum will not be included in the final order. Special order material exceeding the maximum can only be ordered by placing a second truckload order following the requirements above. In-stock material exceeding the maximum can be ordered out of warehouse using your warehouse multiplier. If two colors are ordered, then one color must meet a minimum of 750 cubes or 75 cabinets.

TIMEFRAME

Please confirm current lead times with your Wolf Sales Consultant. Lead times may vary due to current production capabilities and product demand. Turnaround time begins once the order confirmation is approved. The delivery date provided on the confirmation is the earliest date available. If you would like a later date, please communicate with Wolf Customer Care to update your order. Once the order confirmation is approved, the delivery date cannot be changed without penalty. Delivery date changes can only be made in the event of inclement weather. Any non-weather related delivery change will result in additional freight charges where applicable. Customer Care will contact you within 48 hours with your delivery date.

FREIGHT

Truckload orders are FOB from our manufacturing facility. Please request a shipping estimate early in the process to ensure you understand all costs associated with your order. If there is a delay between your estimate and order placement, please ask for an updated shipping estimate.

CHANGES

Once your order confirmation has been approved, the order has been placed into production. No changes can be made after you have approved your order.

TOUCH-UP KITS

Touch-up kits are available for purchase and will ship via FedEx (we cannot ship on the truck with your truckload order). We will coordinate the timing of your touch-up kits to arrive near the delivery time of your truck.

UNLOAD TIME

You will be contacted with a delivery time. Please be prepared to unload the truck immediately upon arrival. There is a two-hour window allowed for unloading. Detention fees will be charged when exceeding the two-hour window. *NOTE: When accepting a Builders Mark direct truck, please have adequate manpower on site to unload in the two (2) hour delivery window. Independent drivers do not assist in unloading. Any time incurred beyond the initial two hours will be charged at \$75.00 per hour.

MOULDING QUANTITIES

All fillers, toekicks and mouldings are sold in full-carton quantities. We are unable to break cartons. See the pieces per carton guide below.

SKU	PIECES/CARTON
F330	10
F342	10
F396	10
F630	10
F642	10
F696	6
LGCROWN4.5-Large Crown	8
MICW-Inside Cover	25
MOCW-Outside Corner	25
MQR-Quarter Round	24
MSW-Scribe	36
SMCROWN212	8
TOEKICK	20
V548ST	5

SUPPORT & SALES AIDS

MERCHANDISING	Item #	NET PRICE	LITERATURE	Unit	NET PRICE
Sample Door Single Standard Sample Door with Drawer Head and Frame	SF	29	Price/Spec Guide	Each	No charge
Standard Door Tiered Display Set 1 Floor Display (15" w x 57" h x 24" d), 1 Harvest Brown Moulding Chain, 1 Color Chip Chain, 6 sample doors and signage	50001923	400	Sell Sheet Brochure	Pack of 25	15
Harvest Brown Moulding Chain Set MDF core wrapped in Low Pressure Melamine; includes all moulding samples measuring 6" each	051MRING 1647413	8	Warranty	Pack of 25	5
Mini-Base – Sierra - Espresso 12" w x 25 1/2 h x 18" d; small base cabinet showing construction and features	MINIBASE 1647412	62			

TOUCH UP KITS & HARDWARE

HARDWARE AND PARTS	Item #	LIST	TOUCH UP	Item #	LIST
HINGE Hinge	1647601	4	STAINPT Espresso – Pint	1647601	38
HINGE6 6-way adjust. hinge for 24" wide cabinet	1914194	4	STAINPT Harvest – Pint	1914194	38
HINGESCREW Hinge screw	1647600	.05	STAINPT Auburn – Pint	1647600	38
SHCLIP Shelf clip	1647608	.25	STAINPT Nutmeg – Pint	2770045	38
BGLIDE Set of R / L Glides for standard base	1647793	24	STAINPT Graphite – Pint	2884533	38
VGLIDE Set of R / L Glides for VANITY base	1647809	24	TUKIT Espresso – Each	1647608	38
BUMPERPAD Bumper pads – 50/pack	1647673	5	TUKIT Harvest – Each	1647607	38
			TUKIT Auburn – Each	1647793	38
			TUKIT Nutmeg – Each	2770046	38
			TUKIT Graphite – Each	2884534	38
			STAINTOPSPRAY Top Coat for Sierra – Spray Can	1647809	35

BUILDERS MARK | 2-YEAR LIMITED WARRANTY

Builders Mark Cabinets from Wolf Home Products have been manufactured under the highest standards of quality and workmanship.

2-YEAR LIMITED WARRANTY

Wolf Home Products warrants that its cabinets and related components ("Products") will be free of all defects in materials and workmanship for two (2) years from date of purchase under normal use subject to the exclusions contained herein.

Warrantor's obligation hereunder is valid only for the standard application in which the Products are used when properly installed in accordance with applicable building codes, conditions, industry acceptable standards and Warrantor's installation instructions. This warranty is not valid for Products used for any purpose other than the purpose for which it was originally intended. Warrantor shall not be responsible for any losses sustained or costs incurred that are reported after the expiration of the two (2) year warranty period.

Warrantor's sole responsibility, and the buyer's sole and exclusive remedy, shall be the refund or replacement, at no additional charge to buyer, or the defective Product. Warrantor shall not be responsible for any consequential damages, lost profits, or any other costs or damages all of which are specifically excluded, including without limitation labor, installation, shipping, transport, disposal, or any costs associated with the Product including without limitation plumbing, walls, flooring, fixtures, gas or electric appliances, or countertops, all of which are specifically excluded.

This warranty does not cover claims arising out of natural characteristics of some wood to split, warp or twist, or natural variations in grain, mineral streaks, knots and color. This warranty does not cover claims arising out of misuse, physical abuse, alteration, accident, improper care in performing necessary upkeep after installation, acts of God, acts of war, vermin or insect infestation, or other chemical or biological factors.

Failure to follow written instructions, restrictions or warnings supplied with the Product shall make the Warrantor's obligation hereunder null and void and of no further effect.

THIS WARRANTY IS THE EXCLUSIVE WARRANTY OF WOLF HOME PRODUCTS AND IS IN LIEU OF AND WOLF HOME PRODUCTS DISCLAIMS ALL OTHER WARRANTIES, EXPRESS OR IMPLIED, INCLUDING IMPLIED WARRANTIES OF MERCHANTABILITY AND FITNESS FOR A PARTICULAR PURPOSE. Some states do not allow the exclusion or limitation of incidental or consequential damages, so the above limitations or exclusions may not apply to you. This warranty gives you specific legal rights, and you may also have other rights which vary from state to state.

To submit a claim under this warranty, contact your Builders Mark cabinets dealer or send a letter explaining the defect along with photo and a dated sales receipt as proof of purchase to the address below.

Builders Mark Cabinets
Attn: Warranty Claims
20 West Market Street
York, PA 17401
phone 800-234-9653
fax 717-792-4052
wolfcabinetswarranty@wolfhomeproducts.com
wolfhomproducts.com
©2016 Wolf Home Products.
All Rights Reserved.





WOLF HOME PRODUCTS™

EFFECTIVE NOVEMBER 2016



KITCHEN & BATH



OUTDOOR LIVING



BUILDING PRODUCTS

wolfhomeproducts.com

All photos are representative of product. Please review an actual product sample with your dealer before making your final selection.

© 2016 Wolf Home Products. All Rights Reserved.



WBM_PCSCGDE_1116_WHP