

Company: _____
 Contact Name: _____
 Address: _____
 City / State / Zip: _____
 Phone #: _____
 Fax #: _____
 Email: _____

Email (or fax) form to your authorized distributor:

Authorized Distributor: _____
 Branch Location: _____
 Email / Fax: _____



Ph: (877) 332-3396 Fx: (704) 332-3267
 www.element-designs.com orders@element-designs.com

Project Name: _____
 Date: _____ PO #: _____

① Glass Type

- 6mm Low-Iron Satin* (Acid Etched)
- 6mm Low-Iron Clear
- 6mm Satin* (Acid Etched)
- 6mm Clear
- 6mm Smoked Grey

*** Satin side facing out**



② Hinge Hardware

79C450BT Self Close Hinge with hinge arm cover & 175H3100 in-line mounting plate always included
 See page 2 for cabinet mounting plate setback calculations

- Include Add-on Blumotion (973A9000)

QTY: _____

- Include TIP-ON for doors

QTY: _____

③ Door Installation

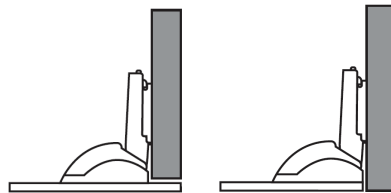

- Overlay**
- Inset

****Must provide Side Overlay dimension, see Page 2 for calculation**

Side Overlay: _____ mm
 (Maximum overlay is 14 mm)

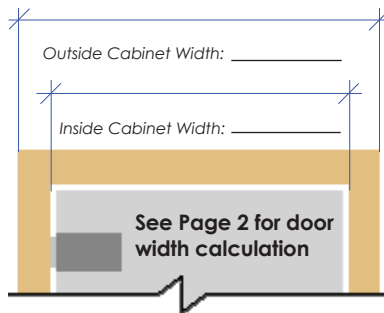

④ Handle Fabrication

- Do not include
- 1 hole per door*
- 2 holes per door*
- Other*: _____

***Must provide Handle dimension on page 2**

Handle grommets included with handle holes must be installed with handle hardware

⑤ Handle Hardware

- | | | |
|-------------------------------|---------------------------------|------------------------------------|
| Natural Anodized | | Brushed Stainless & ORB |
| Knobs | Bar Pulls | Bar Pulls |
| <input type="checkbox"/> K001 | <input type="checkbox"/> P1-127 | <input type="checkbox"/> P1-76S |
| <input type="checkbox"/> K005 | <input type="checkbox"/> P1-190 | <input type="checkbox"/> P1-192S |
| <input type="checkbox"/> K006 | <input type="checkbox"/> P1-250 | <input type="checkbox"/> P1-320S |
| <input type="checkbox"/> K007 | <input type="checkbox"/> P1-380 | <input type="checkbox"/> P1-76ORB |
| <input type="checkbox"/> K008 | <input type="checkbox"/> P1-640 | <input type="checkbox"/> P1-192ORB |
| <input type="checkbox"/> K009 | <input type="checkbox"/> P1-880 | <input type="checkbox"/> P1-320ORB |

QTY: _____

Item	Qty	Dimensions		in OR mm	Left (L)	Right (R)	# Hinges per Door	Element Designs Use Only	
		Width	Height					Price	Ext. Price
1					<input type="checkbox"/> L	<input type="checkbox"/> R			
2					<input type="checkbox"/> L	<input type="checkbox"/> R			
3					<input type="checkbox"/> L	<input type="checkbox"/> R			
4					<input type="checkbox"/> L	<input type="checkbox"/> R			
5					<input type="checkbox"/> L	<input type="checkbox"/> R			
6					<input type="checkbox"/> L	<input type="checkbox"/> R			
7					<input type="checkbox"/> L	<input type="checkbox"/> R			
8					<input type="checkbox"/> L	<input type="checkbox"/> R			

Special Instructions: _____

Knobs/Pulls:	
Hardware:	
Shipping:	
TOTAL:	

Overlay Dimension Examples:

29 mm hinge plate set back dimension calculated for using 175H3100 in-line mounting plate - will not match standard 37mm system mounting plate drilling

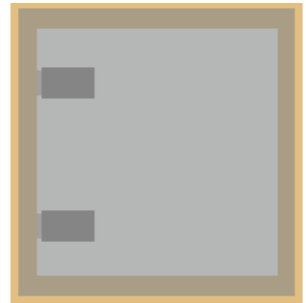
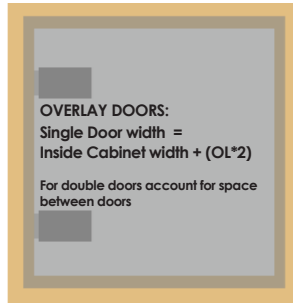
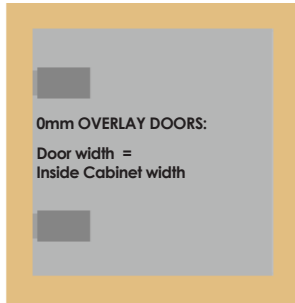
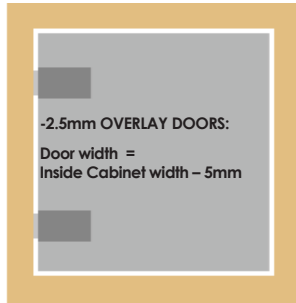
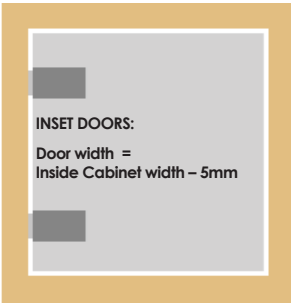
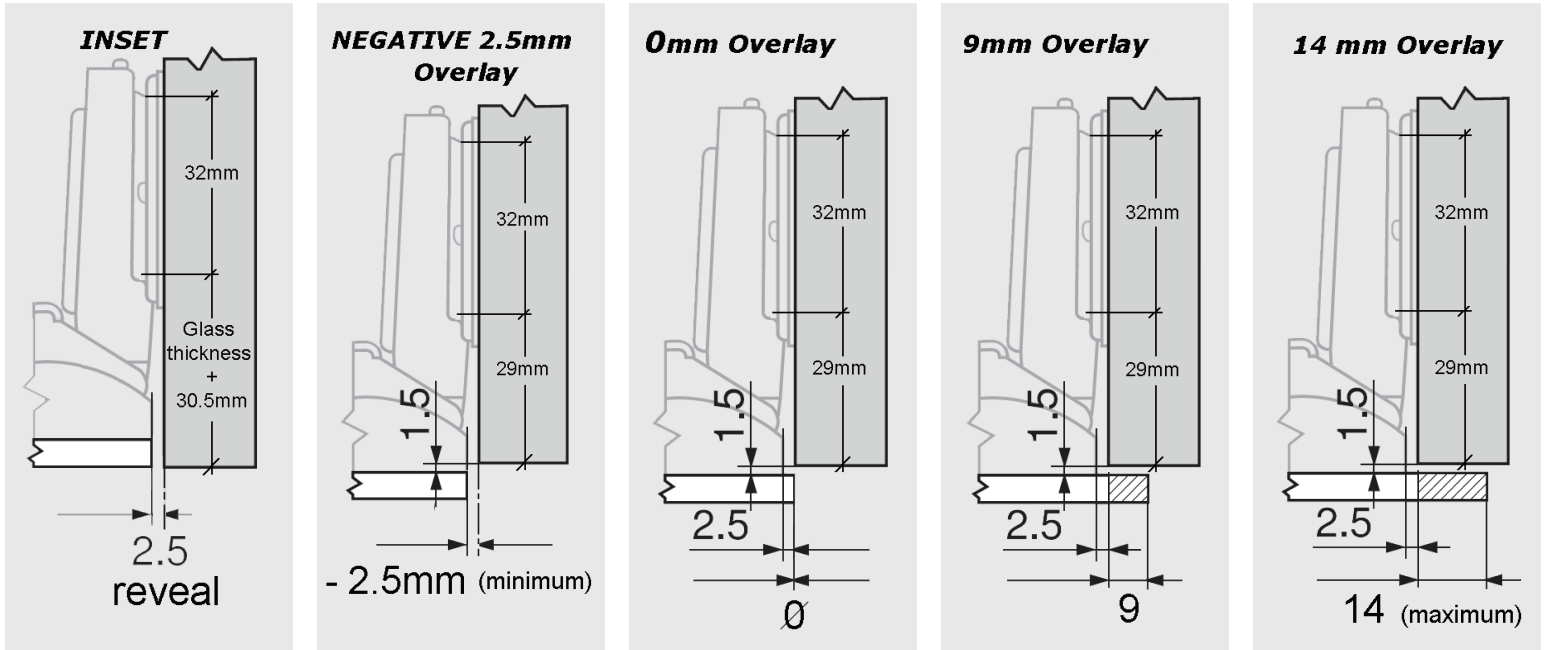

Hinge and Handle Dimension Locations:

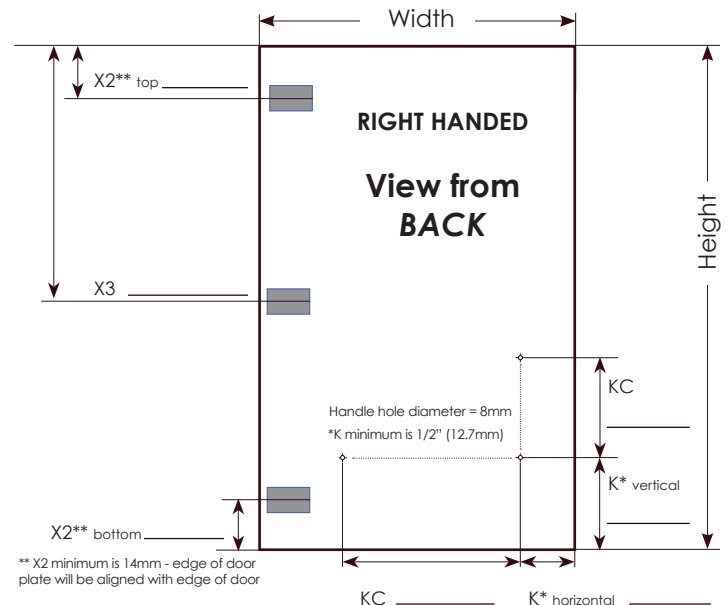
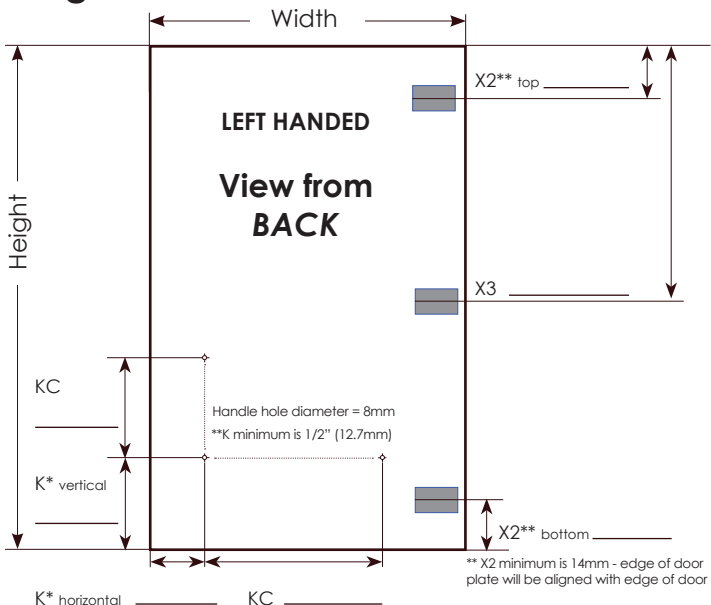

K* horizontal KC

Center handle hole(s) VERTICALLY Center handle hole(s) HORIZONTALLY

KC K* horizontal

Center handle hole(s) VERTICALLY Center handle hole(s) HORIZONTALLY