

Company: \_\_\_\_\_

Contact Name: \_\_\_\_\_

Address: \_\_\_\_\_

City / State / Zip: \_\_\_\_\_

Phone #: \_\_\_\_\_

Fax #: \_\_\_\_\_

Email: \_\_\_\_\_

**Email (or fax) form to your authorized distributor:**

Authorized Distributor: \_\_\_\_\_

Branch Location: \_\_\_\_\_

Email / Fax: \_\_\_\_\_



Ph: (877) 332-3396 Fx: (704) 332-3267  
 www.element-designs.com orders@element-designs.com

Project Name: \_\_\_\_\_

Date: \_\_\_\_\_ PO #: \_\_\_\_\_

**① Door Type**

- Aluminum Frame:
  - AF001  AF002
  - AF003  AF004
  - AF005  AF006\*
  - AF007  AF008
  - AF009  AF010\*
  - AF011

\*AF006 & AF010 available ONLY with opaque Backpainted Glass inserts

**② Profile Finish**

- (Aluminum Frame doors only)
- Anodized Finish
    - Natural Anodized
    - Brushed Stainless
    - Chrome (AF003 & AF010 ONLY)
    - Arctic Gold (AF003 ONLY)
  - Powder Coat Finish
    - Oil Rubbed Bronze
    - White  Black

**③ Opening Info**

Dimensions of space where doors will be installed, used to calculate door dimensions. Use smallest height to calculate door height.

Height (Left): \_\_\_\_\_

Height (Center): \_\_\_\_\_

Height (Right): \_\_\_\_\_

Width: \_\_\_\_\_

**④ Insert Type (select one)**

- Standard Glass Inserts:
  - Satin (Acid Etched)  Lustral D  Reeded (Vertical)
  - Clear  Austral  Reeded (Horizontal)
  - Smoked Grey  Master Carre
  - Low Iron Clear  Low Iron Satin (Acid Etched)

• Backpainted Glass Inserts:

- Finish (select one):
- Gloss  Matte

Paint Color (select one):

- White  Scarlet  Silver
- Black  Olive  Bronze
- Sand  Mocha  Charcoal
- Non-Standard Color: \_\_\_\_\_
- Custom Color\*: \_\_\_\_\_

\*Custom Color match approval & fee applies. Contact Element Designs for details.  
 \*\*Backpainted glass has a light gray backer, unless otherwise specified

• 3form® Resin Inserts:

- Pattern: \_\_\_\_\_

• PARAPAN® High Gloss Inserts:

- Color: \_\_\_\_\_

• Metallic Inserts:

- Aluminum Laminate  Stainless Lam. (Vertical)
- Platinum Ice Acrylic  Stainless Lam. (Horizontal)

• Custom Etch:

- Positive Etch  Negative Etch
- \*Art work must be supplied, subject to set up fee. Contact Element Designs for details.

all inserts are 5/32" (4mm) thick  NO INSERT

All glass is tempered safety glass & will not have etched tempered logo unless otherwise specified at time of order. Refer to local building codes.

**⑤ Sliding Hardware Selection**

See sliding door technical manual for hardware specifications

**A. Track (select one)**

- Inset - single only

**B. Planes of Travel & Number of Doors**

- 1 Plane - 1 Door
- 1 Plane - 2 Doors
- 2 Planes - 2 Doors
- 2 Planes - 3 Doors
- 2 Planes - 4 Doors
- Other (Please Specify details in Special Instructions)

**C. Track Finish (Select one)**

- Natural Anodized  Oil Rubbed Bronze
- Brushed Stainless not available  White  Black

Four door carriers per door will be included and preinstalled on each door.

**⑥ Decorative Hardware & Handles**

- Drill for handle holes (Must specify handle location on pg 2)

Natural Anodized		Brushed Stainless & ORB		Various Finishes	
Knobs	Bar Pulls	Bar Pulls	Finger Pulls		
<input type="checkbox"/> K001	<input type="checkbox"/> P1-127	<input type="checkbox"/> P1-76S	<input type="checkbox"/> P2-42		
<input type="checkbox"/> K005	<input type="checkbox"/> P1-190	<input type="checkbox"/> P1-192S	<input type="checkbox"/> P2-42S		
<input type="checkbox"/> K006	<input type="checkbox"/> P1-250	<input type="checkbox"/> P1-320S	<input type="checkbox"/> P2-42ORB		
<input type="checkbox"/> K007	<input type="checkbox"/> P1-380	<input type="checkbox"/> P1-76ORB			
<input type="checkbox"/> K008	<input type="checkbox"/> P1-640	<input type="checkbox"/> P1-192ORB			
<input type="checkbox"/> K009	<input type="checkbox"/> P1-880	<input type="checkbox"/> P1-320ORB	<input type="checkbox"/> Other		

QTY: \_\_\_\_\_

Item	Qty	Door Dimensions (See page 2)		in OR mm	Divider Rails		Element Designs Use Only	
		Width	Height		(See Page 2)	Qty	Price	Ext. Price
1					<input type="checkbox"/> yes <input type="checkbox"/> no			
2					<input type="checkbox"/> yes <input type="checkbox"/> no			
3					<input type="checkbox"/> yes <input type="checkbox"/> no			

Special Instructions: \_\_\_\_\_

Knobs/Pulls : \_\_\_\_\_

Hardware : \_\_\_\_\_

Shipping : \_\_\_\_\_

T O T A L : \_\_\_\_\_

## Door Dimension Calculations:

### Inset Track:

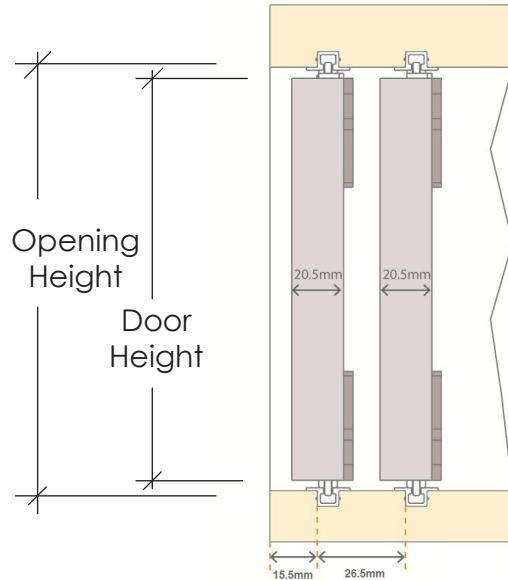

$$\text{Door Height} = \text{Opening Height} - 5\text{mm}$$

$$\text{Door Width} = (\text{Opening width} \div \# \text{ of doors}) + (\text{profile width} * \div 2)$$

*Profile Width: AF001 = 3/4" (20.5mm)	AF004 = 1 3/4" (45mm)	AF007 = 2 3/4" (70mm)	AF010 = 2 1/8" (54mm)
AF002 = 2 1/8" (54mm)	AF005 = 1 3/4" (45mm)	AF008 = 3/4" (20.5mm)	AF011 = 2 1/4" (57mm)
AF003 = 2 1/8" (54mm)	AF006 = 1 3/4" (45mm)	AF009 = 2 1/2" (63.5mm)	

## Divider Rail Inserts & Locations:

Divider Rails ONLY available with AF001, AF003, AF005, AF007, & AF009 - Rail width = 3/4"

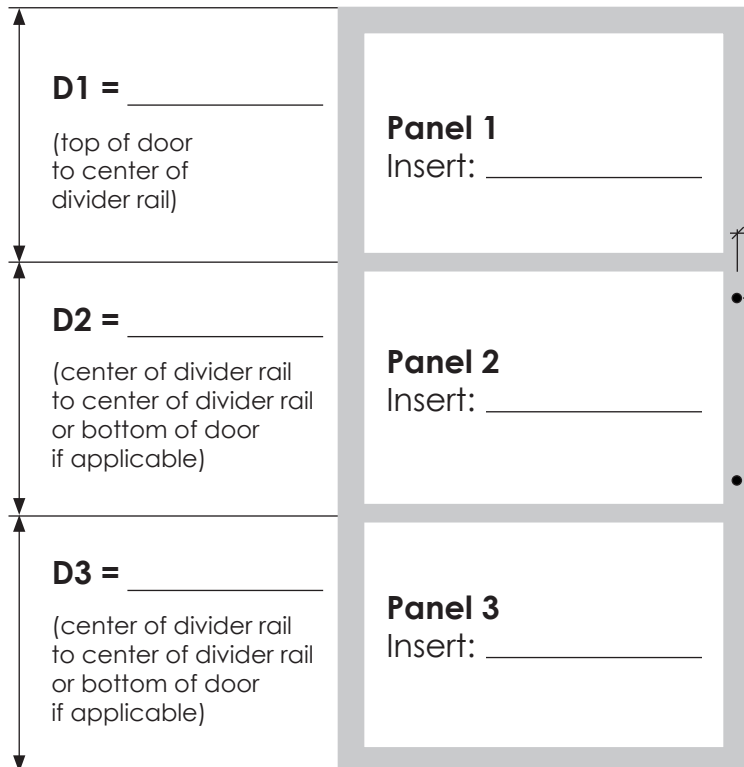

### Handle Location:

Handle Hole Diameter = 11/64" (4.37mm)

\*For handle holes in glass, the white plastic grommet cover included with the door should be left in place when handle or knob hardware is installed.

**K1 =** \_\_\_\_\_  
Knob or Pull  
(Std = centered on frame)

**KC =** \_\_\_\_\_  
Center to center of Pull

**K2 =** \_\_\_\_\_  
Knob or Pull  
(Min = 2 1/4", Std = 2 1/2")

### Hardware Dimensions:

